

34228

608 Ridgewood Rd., Mplwd.

^{155,000}
\$159,900

1F



34228

608 Ridgewood Rd., Mplwd.

^{155,000}
\$159,900

1F

Corner Winthrop Pl.

Lot: 119x152x135x128 Lot 265 Bk 1-8 Plt 9

Col, stucco, comp. rf, all ss/scrs, 220 amps.

1st-4-vest, ch, lr w/fp, dr, kit, bath, den/fam. rm.

2nd-4-4 brs, 2 baths.

3rd-1-1 br, stge.

Bsmt-rec. rm, laund, canning rm, powder rm, furnace rm.

ST: Oil

2-car det. garage, paved drive

L-51.4 B-60.4 '81 Rate \$3.46 Taxes \$3868.28 Poss:

Immed. or 30 days. Key w/L.R. & D & H. Gracious
center hall colonial in charming Jefferson area.

Brand new exquisite kit. + all other beautiful
amenities. This is fantastic. Jefferson GS, Mplwd.

Jr., Columbia HS, St. Josephs Paro. Bus 31. Mplwd.

RR Sta. Subject to errors & omissions.

NOT FOR RENT.

LR: GLS 762-7214 60012002/110024002 (CB 2.5 - \$45)

Owner: John Ferrari, c/o L.R.

Conv. 608 Ridgewood Rd., Mplwd. 9-3-2 5 brs. \$159,000.

#8346--8/4/82 VACANT & MUST BE SOLD. Key w/LR, D&H.

#8342--7/26/82 Key w/C. Danzi, D&H, Weichert S.H. Burdorff
& Sands.

#8343--7/28/82 VACANT. Anxious.

#8352--8/18/82 MUST BE SOLD. Add: elec. fire alarm
system thruout house.

#8355--8/25/82 Price reduced to \$155,000. Immed. poss.

#8367--9/23/82 Will consider financint w/sub down or rental
w/option to buy w/money up front

BA 82

RED 6/83 Selling price \$135,000

•32271

608 Ridgewood Rd., Mplwd.

\$105,000

1F

4/82
87,000

32271 608 Ridgewood Rd., Mplwd. \$105,000 1F

Corner Winthrop Pl. Map Grid K-9

Lot: 119x152x135x128 Lot 265 Blk 1-8 Plt 9

Col, stucco, comp. rf, part scrs, 110 VS, 60 amps.

1st-5-vest, ch, lr w/fp, dr, kit, br, bath, enc. porch.

2nd-4-4 brs, 2 baths, both w/s.o.t., dressing rm. off
tremendous M.br.

3rd-1-br, close strs, lrg. attic stge.

Bsmt-rec. rm, toi, laund, out. ent.

ST: Oil 1000 gal. tank

2-car stucco det. garage, paved drive

L-51.4 B-60.4 '81 Rate \$3.46 Taxes \$3868.28 Poss: 90
days o.a.a. Gracious, older home w/exceptionally lrg.
lr & M.br. M.br w/fp. Beautiful rear yard, fenced-in
w/patio. A great family home, near to stores & trans-
portation. PLEASE ALWAYS CALL FOR APPT. TO SHOW AS
MR. BEAM IS A WHELL CHAIR PATIENT. YOUR COURTESY
VERY MUCH APPRECIATED. Jefferson/Marshall GS, Mplwd.
Jr., Columbia HS, St. Joseph Paro. Bus 31. Mplwd. RR
Sta. Subject to errors & omissions.

LR:PJC 379-7484 100010001/30031002 (CB 3 - \$45)

Owners: John V. & Ruth E. Beam, Jr., Prem., 762-7377.

Conv. 608 Ridgewood Rd., Mplwd. 10-3-2 6 brs. \$105,000.

#8239--11/16/81 Annual oil consumption last yr 2,000 gals.

Roof was new 4 yrs, ago

#8252--12/16/81 ALL APPTS THRU L.R.DUE TO ILLNESS

#8273--2/10/82 Do NOT show until further notice.

Due to death of MRS. Beam

#8276--2/17/82 Ppty can now be shown. Call 762-7377 for
all appts. Will consider financing to qual. buyer.

#8293--3/29/82 SOLD.

#8303--4/22/82 Sale comp.. Selling price \$81,000 PMM.

OK 10/11/30 - 12/31/31

BNH 1/21/30 2/3/32 J. V. Beam Estate - owner

Stucco House Built 1909
lot 119 x 152 X 128, 4 x 135, 87
Mtg. \$15,000 B & L reduced to abt 9300
(& glassed)

8 rooms, 2 baths, 2 screened/porches
2 open fireplaces
2-car garage steam heat

see sketch for
water right of way

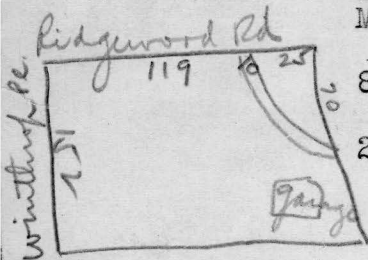

see listing 7/5/32

608 Ridgewood Road

Maplewood

8-2-2

12/31/31 - \$20,000
~~\$25,000~~

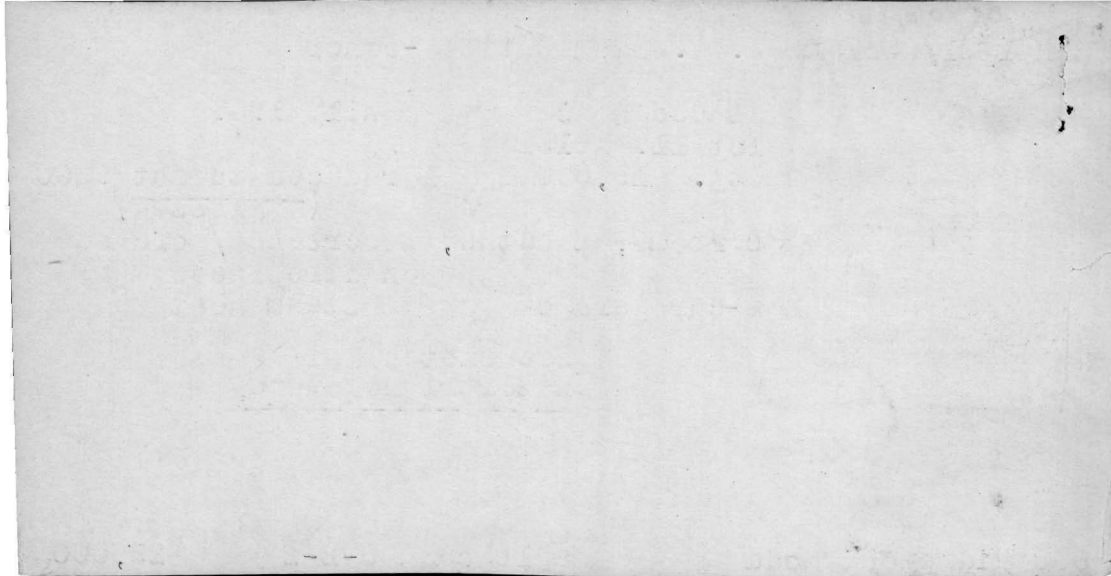

OK 3/1/29

Open listing,
9/4/28
BNH.

J.V.
Mrs. Beam, owner,
East Orange, N.J.

Sold by

Stucco house,
Lot 119x152
Mtg. \$15,000 B & L reduced to [#]9350

Martin & Weiss

8 rooms 2 baths 2 car garage.

\$18800

2 open fireplaces,

1/14/29

Built 1909

Steam heat, 2 screened and glassed porches

deal did not go thru

608 Ridgewood Road. Maplewood. 8-2-2 \$35,000

Mrs. Ben, owner,
East Orange, N.J.

Open listing,
9/4/38
B.H.

Lot 119112
128. 516, 000 B & I reduced to 9250

8 rooms 2 baths 2 car garage.

2 open fireplaces,
Built 1909
Steam heat, 2 screened and glazed porches

Mr. Gedney
phoned GMD
7/5/32

Mrs. J. V. Beam -owner -Or. 3- 6200
c/o Stanley L. Gedney, Jr.,
525 Main St., East Orange, N. J.

Stucco House, Built lot 119 x 152
Mtg. 1909

8 rooms, 2 baths 2 open fireplaces
2 screened porches & glassed
2-car garage steam heat

Spent \$7500 on alterations

Out

Beam

Mrs. Beam

Living

1/30/33

